



648 FILLMORE STREET

SAN FRANCISCO

PROPERTY SQ FT INFORMATION

MEASUREMENTS CALCULATED TO THE INTERIOR WALLS

LIVING SPACE: 4374 SQ FT

- * Main House (Main Entry): 46 Sq Ft
- * Main House (Main Level): 2205 Sq Ft
- * Main House (Upper Level): 2123 Sq Ft

NON-LIVING SPACE: 791 SQ FT

- * Main House Lower Level: 791 Sq Ft

COMBINED: 5165 Sq Ft



PRESENTED BY : AMY CLEMENS AND ALEC MIRONOV
DRE #: AMY: 01268379 / ALEC: 1873983

DISCLAIMER: RENDERING BY OPEN HOMES PHOTOGRAPHY. ALL MEASUREMENTS ARE APPROXIMATE AND MAY NOT BE EXACT.
DO NOT RELY ON THE ACCURACY OF THIS FLOOR PLAN WHEN DETERMINING THE PRICE OF A PROPERTY OR MAKING DECISIONS
REGARDING BUYING OR SELLING OF PROPERTIES WITHOUT INDEPENDENT VERIFICATION.



648 FILLMORE STREET

SAN FRANCISCO

PROPERTY SQ FT INFORMATION

MEASUREMENTS CALCULATED TO THE INTERIOR WALLS

LIVING SPACE: 4374 SQ FT

- * Main House (Main Entry): 46 Sq Ft
- * Main House (Main Level): 2205 Sq Ft
- * Main House (Upper Level): 2123 Sq Ft

NON-LIVING SPACE: 791 SQ FT

- * Main House Lower Level: 791 Sq Ft

COMBINED: 5165 Sq Ft

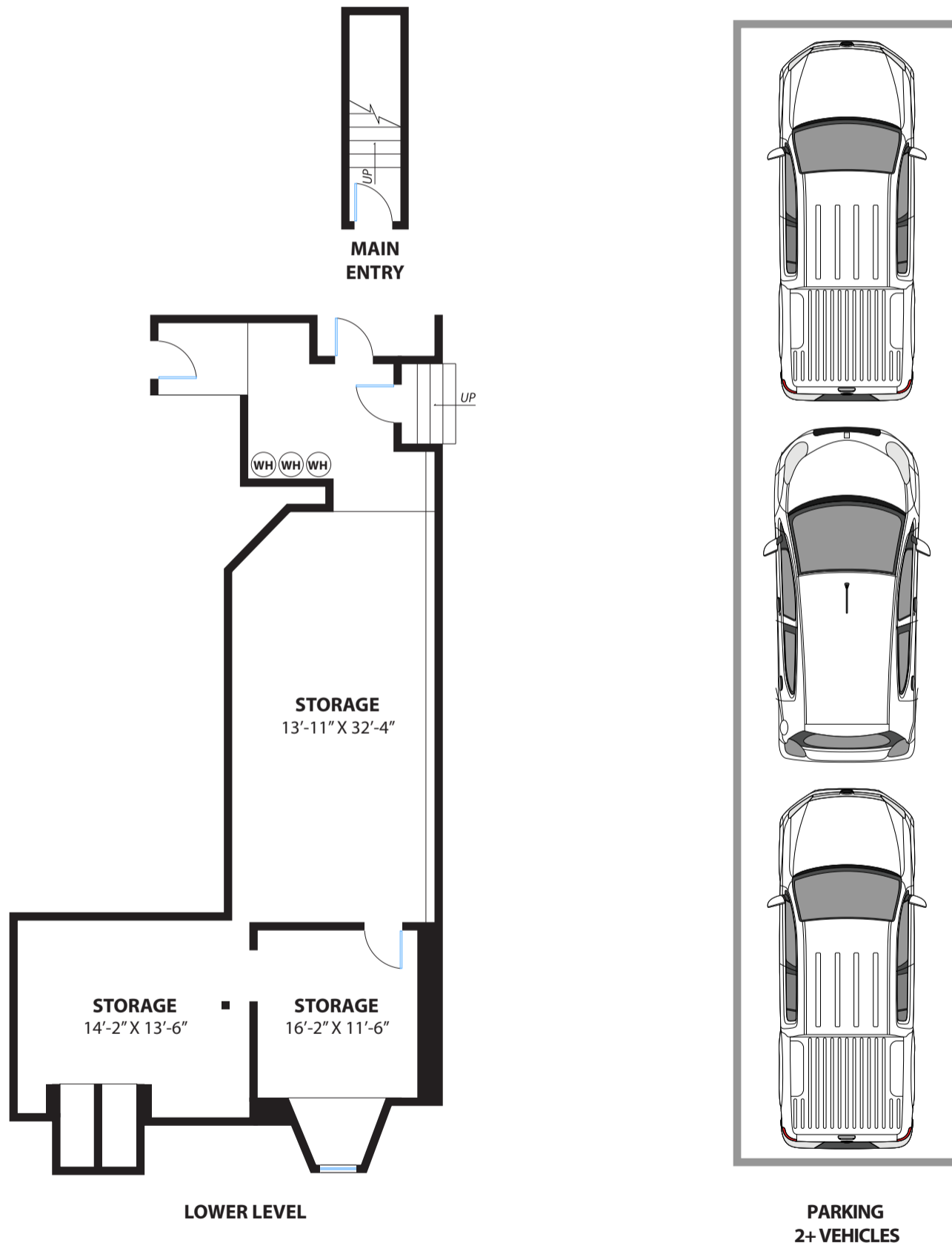

PRESENTED BY : AMY CLEMENS AND ALEC MIRONOV
DRE #: AMY: 01268379 / ALEC: 1873983

DISCLAIMER: RENDERING BY OPEN HOMES PHOTOGRAPHY. ALL MEASUREMENTS ARE APPROXIMATE AND MAY NOT BE EXACT.
DO NOT RELY ON THE ACCURACY OF THIS FLOOR PLAN WHEN DETERMINING THE PRICE OF A PROPERTY OR MAKING DECISIONS
REGARDING BUYING OR SELLING OF PROPERTIES WITHOUT INDEPENDENT VERIFICATION.